



AEROQUIP INNOVATIONS

Introducing... The Easy, Quick, and High-Tech Way to Change Your Oil — Aeroquip's **QUICK-DRAIN** Oil Pan Coupling...

Benefits

- Great for streetcars, hot rods, boats, race-cars, anything that you need to drain oil from in a clean and efficient way. Makes changing your oil quick, clean, and fun!
- Eliminates the potential of oil spillage — drains directly into waste oil container.
- Able to change oil when hot.
- One-hand connect/disconnect.
- Race quality, double-seal construction.
- Wide range of applications — sizes for most popular light cars and trucks.
- Easy to connect — no drain plug to remove.



Easy to Install, Easy to Use.

- Remove oil drain plug (and oil) and replace drain plug with the male half of Aeroquip's **QUICK-DRAIN*** coupling. Torque to correct specifications** (*Figure #1*).
- Install cap and refill engine with oil. Your installation is complete!
- To drain oil, remove cap and push the female half onto the male half (*Figure #2*).
- Route hose from female half into waste oil container.
- Pull back sleeve on female coupling and disconnect. Replace cap and refill engine with oil.
- Oil change complete — quick and easy (*Figure #3*).

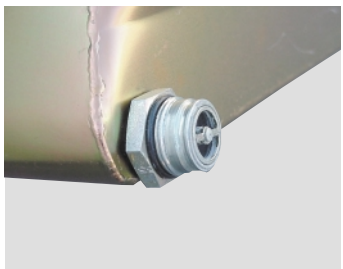

(Figure #1)

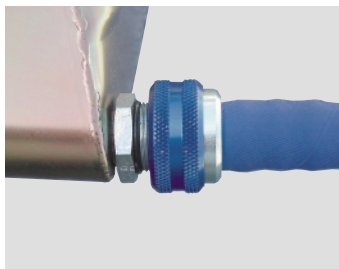

(Figure #2)



(Figure #3)

* You must check and confirm your vehicle has proper clearance for the installation and use of this product.

**Failure to meet minimum assembly torque could result in fluid leakage.

Part Numbers and Descriptions

Part Number	Description	Thread Size	A	B	Hex Size	Min. Assembly Torque
			Dimension	Dimension		
			INCHES	INCHES	INCHES	POUNDS/FOOT
FCM3126 [^]	Full Flow Male Half	1/2 - 20 UNF-2A*	1.52"	.96"	1-1/16"	20-24 [†]
FCM3127	Full Flow Male Half	M18 x 1.5 6g*	1.52"	.96"	1-1/4"	20-40 [†]
FCM3128	Full Flow Male Half	M14 x 1.25 6g*	1.52"	.96"	1-1/16"	20-24 [†]
FCM3129	Full Flow Male Half	5/8 -18 UNF-2A*	1.52"	.96"	1-1/16"	20-40 [†]
FCM3130	Full Flow Male Half	3/4 -16 UNF -2A**	1.54"	.96"	1-1/4"	30-50 [†]
FCM3131	Full Flow Male Half	7/8 -14 UNF -2A**	1.54"	.96"	1-1/4"	30-60 [†]
FCM3132	Full Flow Male Half	M20 x 1.5 6g**	1.54"	.96"	1-1/4"	30-60 [†]
FCM3133	Full Flow Male Half	M22 x 1.5 6g**	1.54"	.96"	1-1/4"	30-60 [†]
FCM3134	Full Flow Male Half	1-1/16 - 12 UN - 2A**	1.54"	.96"	1-1/2"	30-60 [†]
FCM3135	Full Flow Male Half	M12 x 1.5 6g*	1.52"	.96"	1-1/16"	20-24 [†]
FCM3136	Full Flow Male Half	M14 x 1.5 6g*	1.52"	.96"	1-1/16"	20-24 [†]
FCM3137	Full Flow Male Half	M12 x 1.75 6g*	1.52"	.96"	1-1/16"	20-24 [†]
FCM3117	Full Flow Female Half	Fits All	2.34	1.50	-	-
FCM3118	Replacement Cap	Fits All	0.726	1.25	-	-
FCM3119	Replacement Gasket	Fits: 1/2-20, M12 x 1.5 M12 x 1.75	-	-	-	-
FCM3120	Replacement Gasket	Fits: M14 x 1.25 M14 x 1.50	-	-	-	-
FCM3121	Replacement Gasket	Fits 5/8 -18	-	-	-	-
FCM3122	Replacement Gasket	Fits: 3/4 -16 M18 x 1.50	-	-	-	-
FCM3123	Replacement Gasket	Fits: M20 x 1.50	-	-	-	-
FCM3124	Replacement Gasket	Fits: 7/8 -18 M22 x 1.50	-	-	-	-
FCM3125	Replacement Gasket	Fits: 1-1/16 -12 UN	-	-	-	-
FBV1000	Blue SOCKETLESS [®] Hose (dash 10)	SPECIFIC LENGTH	-	-	-	-

[^]Male half comes complete with anodized aluminum cap and gasket

[†]Failure to meet minimum assembly torque could result in fluid leakage. Caution: Do not over torque

Flow Rate (17°F 10W30 Oil)

*Approximately 0.24 GPM

**Approximately 0.68 GPM

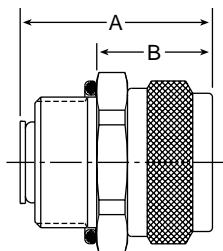

Male Half Assembly
Coupling Size is -06

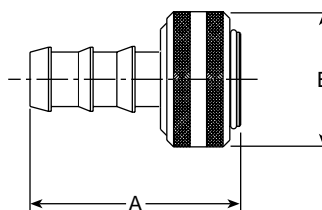

Female Half Assembly
Coupling Size is -06
5/8" Push-on Hose Barb

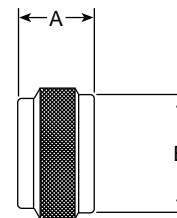

Cap

Eaton
14615 Lone Oak Rd.
Eden Prairie, MN 55344-2287
USA
tel: 952 937-7351
fax: 952 937-7394
www.aeroquip.com



Aeroquip