

Check Valves



Pilot Operated Check Valve

4CT-06-(D)*-21
 4CS-06-(D)*-21
 4CG-06-(D)*-21

Model	Spring	Pressure PSI	Check- Valve	Guide/ Poppet
4C*-06-A-21	354636	30	359859	359860
4C*-06-DA-21			342366	354644
4C*-06-B-21	386660	50	359859	359860
4C*-06-DB-21			342366	354644
4C*-06-C-21	388352	75	359859	359860
4C*-06-DC-21			342366	354644
4C*-06-F-21	388353	150	359859	388358
4C*-06-DF-21			342366	388359

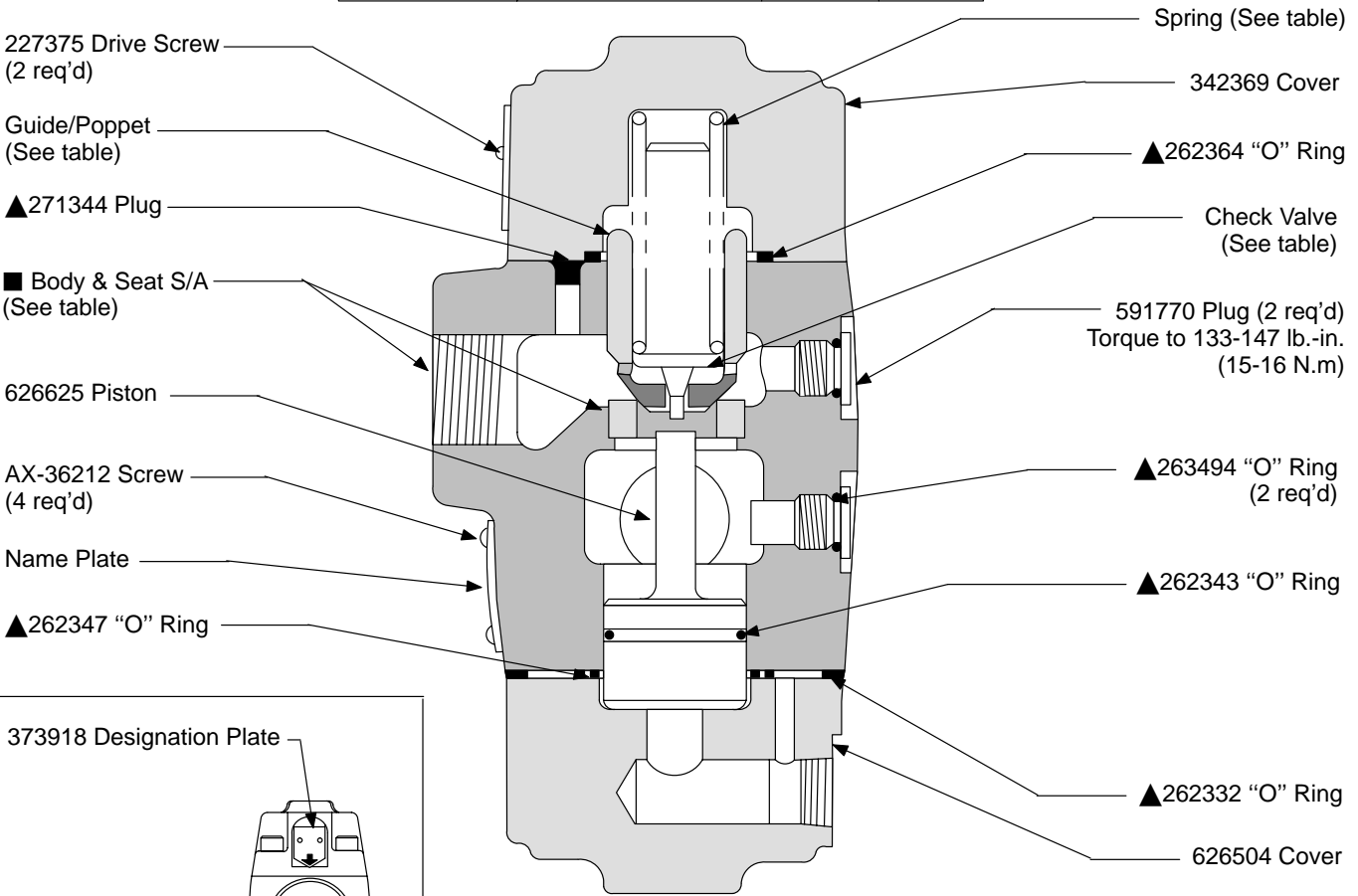

Model	■ Body S/A	Body	Seat
4CS-06-(D)*-21	626607	626608	342365
4CT-06-(D)*-21	626505	626506	342365

▲ Service all units with
 F3 Seal Kit 919675

Model Code

(F3) - 4C * - 06 - (D) * - 21

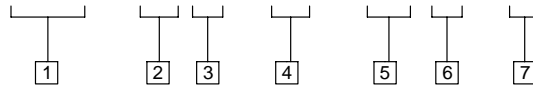

1 Seals

(F3) - Seals for mineral oil and fire resistant fluids

2 Model Series

4C - Pilot operated check valve

3 Connection

G - Subplate mounted
S - SAE straight thread connection
T - NPTF threaded connection

4 Series

06 - 60

5 Features

D - Decompression
(Omit for no decompression)

6 Pressure Range

A - 30 PSI
B - 50 PSI
C - 75 PSI
D - 150 PSI

7 Design

4CG-06-(D)*-21

▲ Service all units with F3 Seal Kit 919675

626507 Body & Seat S/A Includes:
342365 Seat
626508 Body

Model	Spring	Pressure PSI	Check-Valve	Guide/Poppet
4CG-06-A-21	354636	30	359860	359859
4CG-06-DA-21			354644	342366
4CG-06-B-21	386660	50	359860	359859
4CG-06-DB-21			354644	342366
4CG-06-C-21	388352	75	359860	359859
4CG-06-DC-21			354644	342366
4CG-06-F-21	388353	150	388358	359859
4CG-06-DF-21			388359	342366

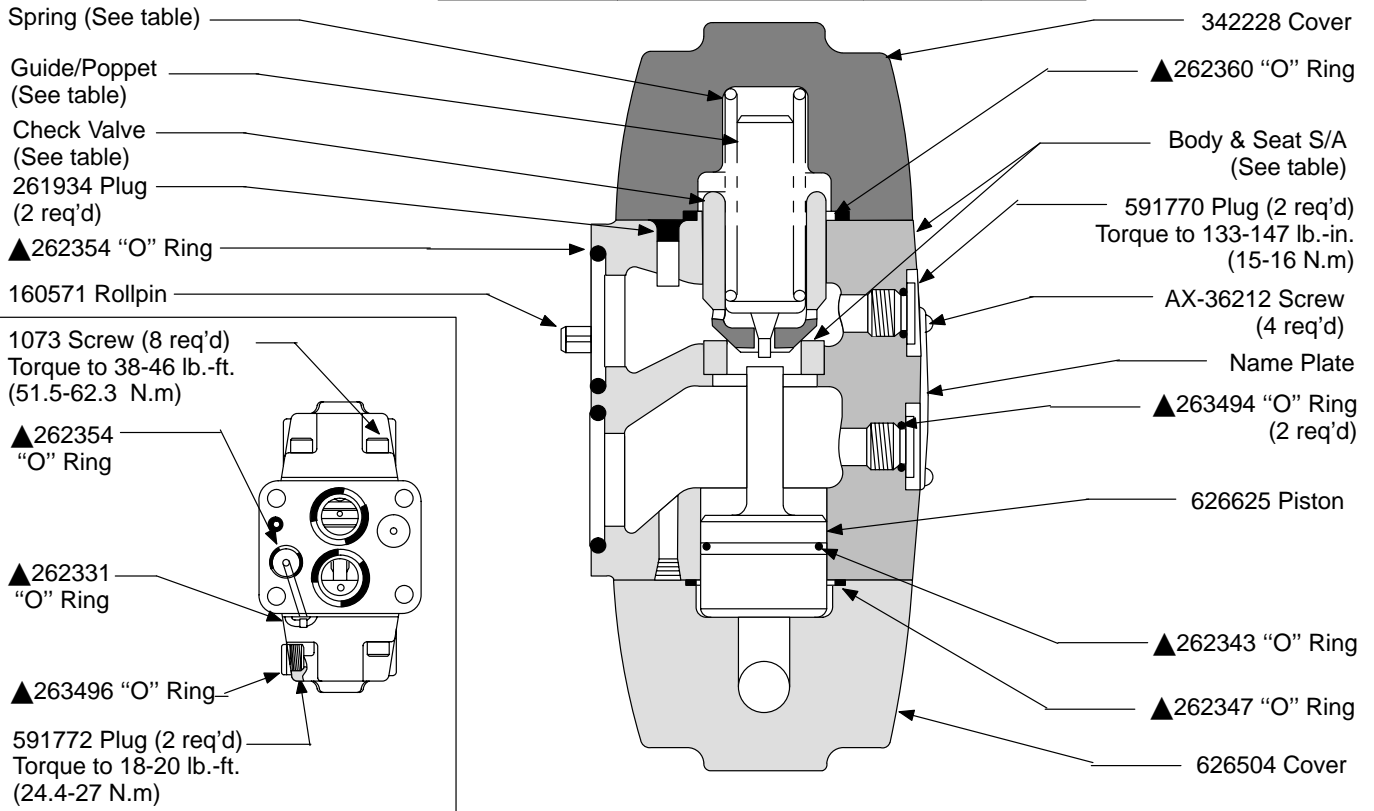

For satisfactory service life of these components, use full flow filtration to provide fluid which meets ISO cleanliness code 18/15 or cleaner. Selections from Eaton OFF, OFR and OFRS filter series are recommended.