

# Flow Controls



## Flow Control Valves

FRG-03-28-21

F(C)G-03-28-20/22

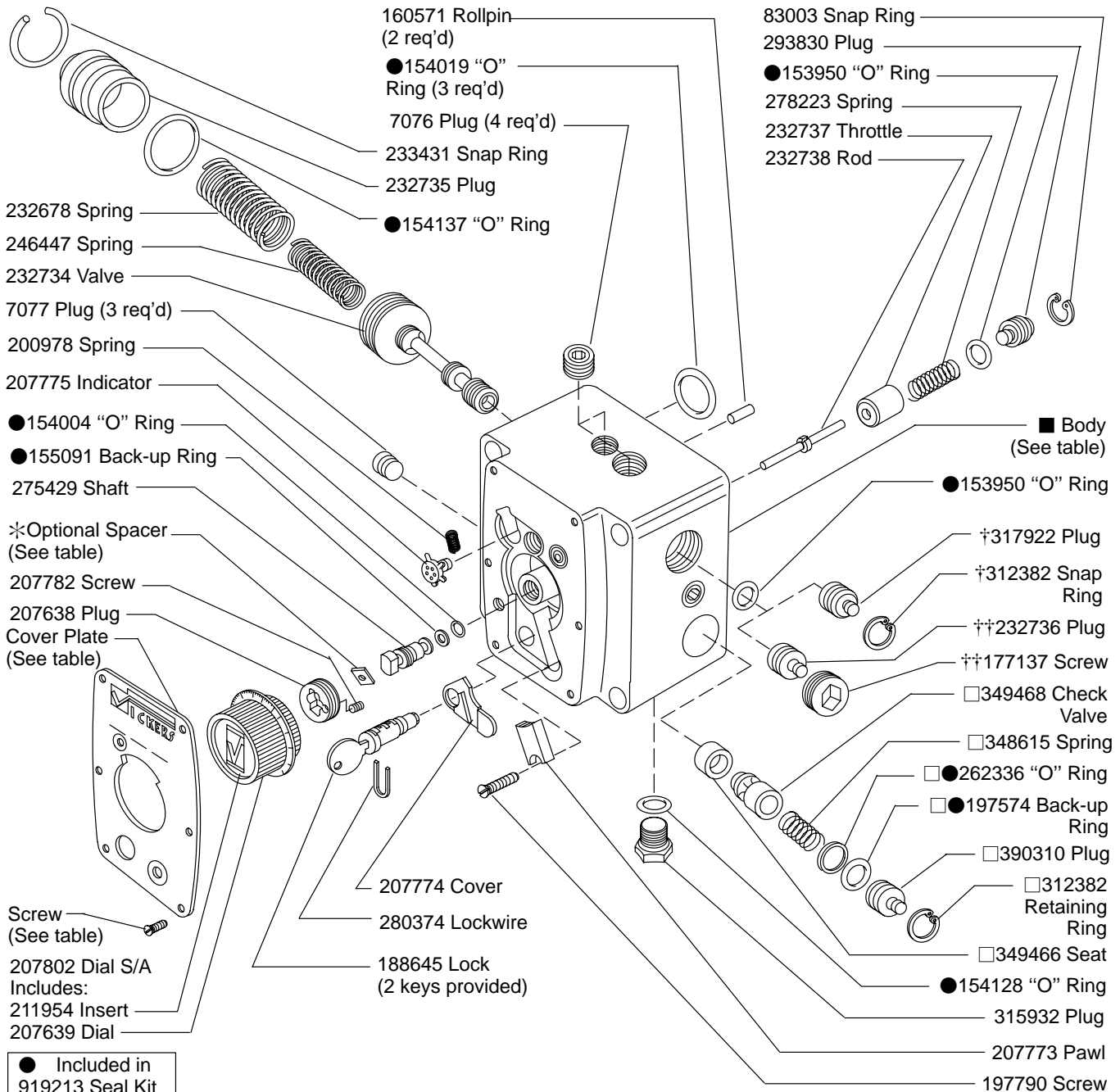

● Included in 919213 Seal Kit

F3 equivalent 919398 Seal Kit

| Model         | Name Plate | Screw (6 req'd) | ■ Body |
|---------------|------------|-----------------|--------|
| FG-03-28-20   | 232740     | 184173          | 232732 |
| FG-03-28-22   | 315975     | 3X-117655       | 330937 |
| FRG-*.**.*-22 |            |                 | 390309 |

\*Optional spacers (211026) are available to limit the maximum throttle opening as follows:

| Number of Spacers | Limit of Maximum Volume USgpm |
|-------------------|-------------------------------|
| 3                 | 4.5 to 6                      |
| 2                 | 10 to 13                      |
| 1                 | 18 to 21                      |

† Used on -22 Design only

†† Used on -20 Design only

□ Used on FCG Models only

**FRG-03-28-21**

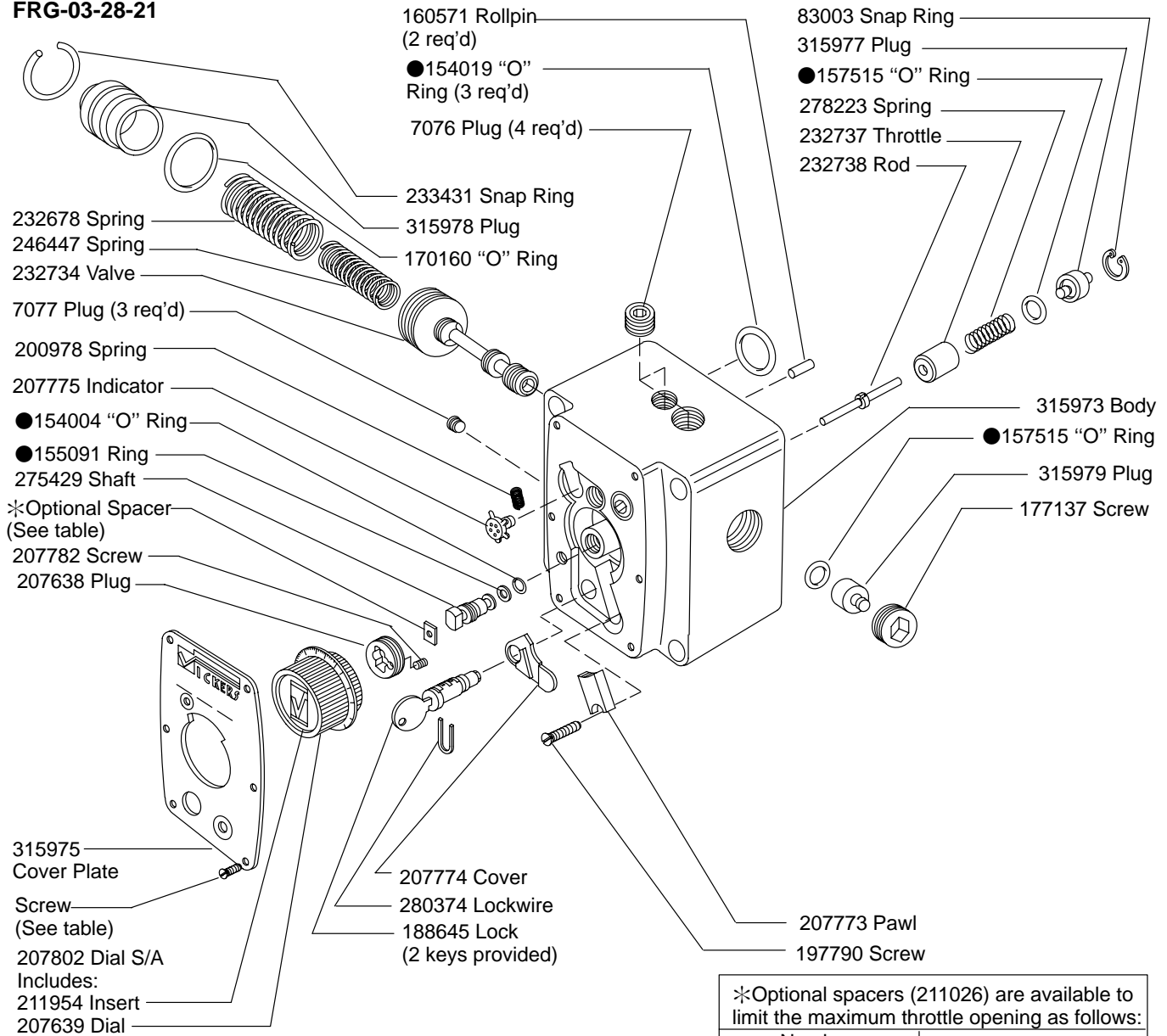

● Included in 919425 Seal Kit

\*Optional spacers (211026) are available to limit the maximum throttle opening as follows:

| Number of Spacers | Limit of Maximum Volume USgpm |
|-------------------|-------------------------------|
| 3                 | 4.5 to 6                      |
| 2                 | 10 to 13                      |
| 1                 | 18 to 21                      |

**Model Code**

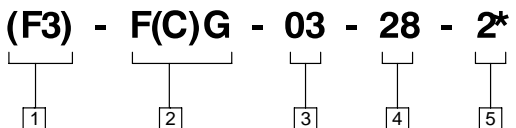

|   |                       |   |
|---|-----------------------|---|
| <b>1</b> Seals<br>F3 - Multi-fluid capability                             | <b>3</b> Series<br>03 | <b>4</b> Maximum Capacity (USpgm)<br>28 |
| <b>2</b> Model Series<br>FRG - Flow control, relief valve, gasket mounted |                       | <b>5</b> Design                         |

For satisfactory service life of these components, use full flow filtration to provide fluid which meets ISO cleanliness code 18/15 or cleaner. Selections from Eaton OFF, OFR and OFRS filter series are recommended.

Printed in U.S.A.