

Control Valves



Flow Control Valves

F(R)G-06-*-11/12/13

Model	Inner Spring	Outer Spring	Valve	●Body S/A	Sleeve
(F3)-FG-06-*-*	271434	104998	105504	132069	307516
(F3)-FRG-06-*-*	-		105587	296663	105503

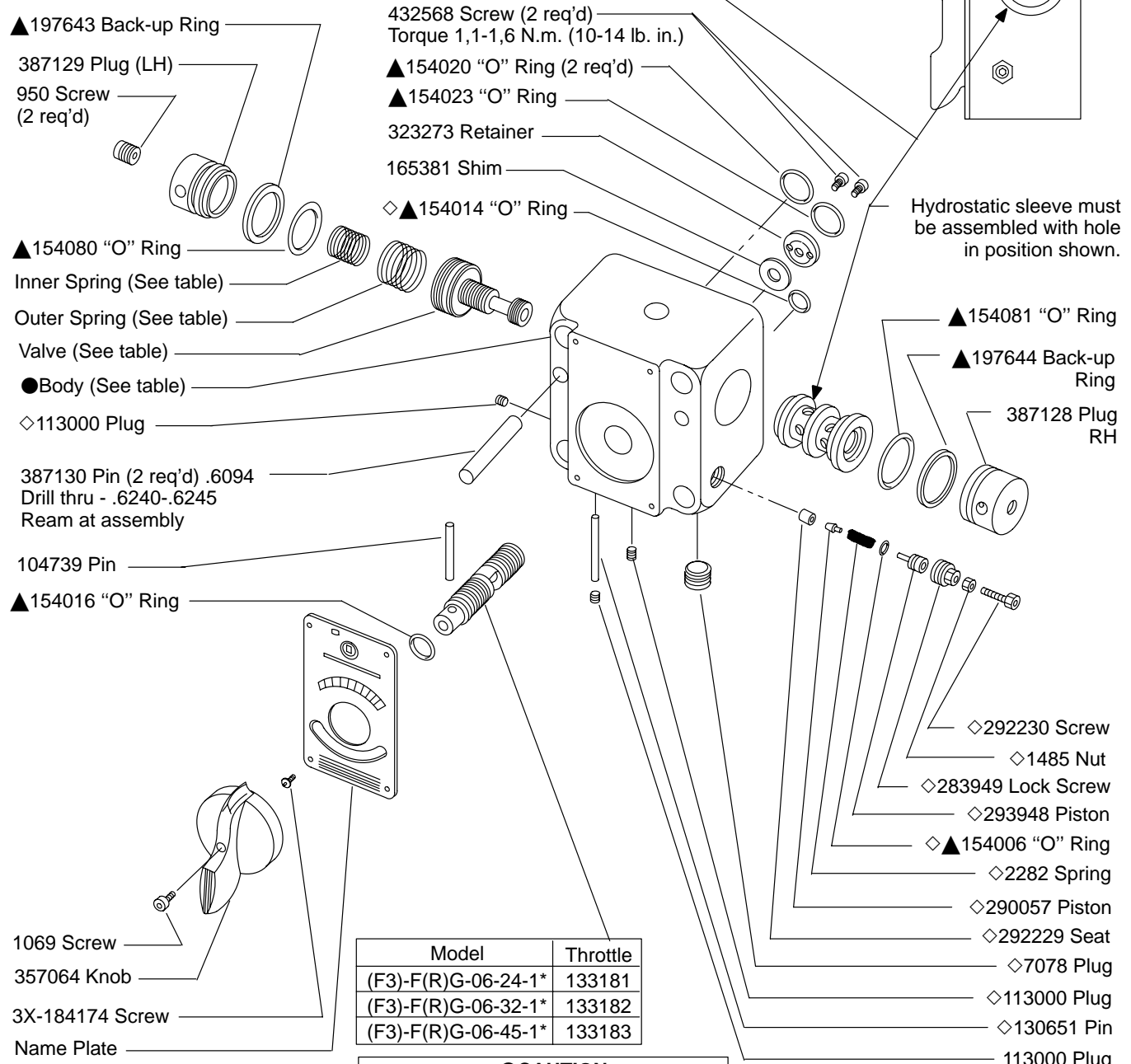

Model	Throttle
(F3)-F(R)G-06-24-1*	133181
(F3)-F(R)G-06-32-1*	133182
(F3)-F(R)G-06-45-1*	133183

F3 equivalent Seal Kit 919897

▲Included in 919449 Seal Kit

●CAUTION

Add lead chamfer to cross pin hole in hydrostat sleeve bore to prevent cutting "O" ring at assembly.

◇ FRG Models only

(F3)-F(R)G-10-*-12/13
(F3)-FG-10-*-15

Model	Outer Spring	†Valve	●Body S/A	†Sleeve
(F3)-FG-06-*-*	122990	376086	246429	376085
(F3)-FRG-06-*-*	104697	*105587	292228	*104728

†Valve and Sleeve must be replaced as a sub-assembly in the FG-10-*-12/13 models

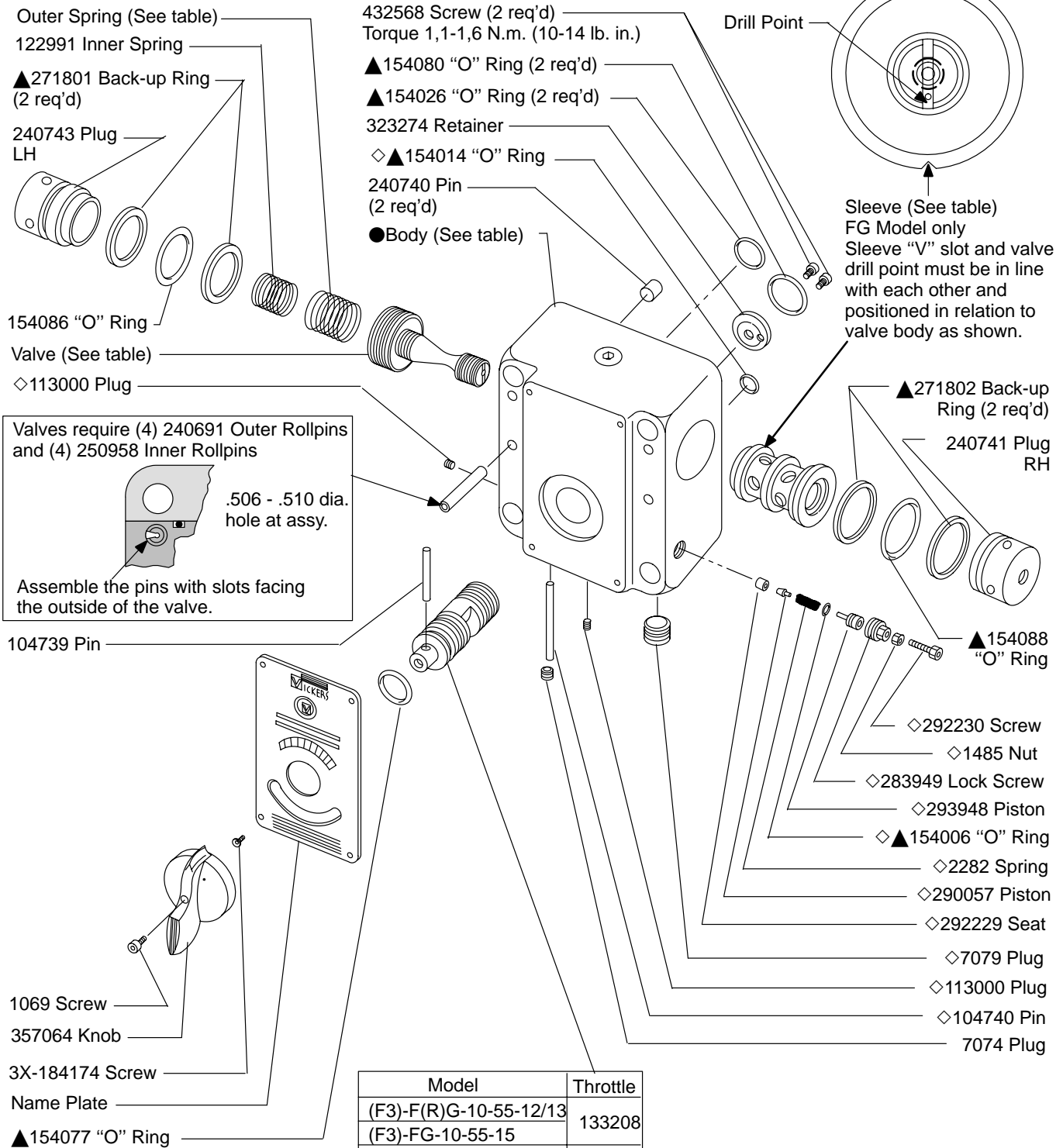

Model	Throttle
(F3)-F(R)G-10-55-12/13	133208
(F3)-FG-10-55-15	
(F3)-F(R)G-10-75-12/13	133207
(F3)-FG-10-75-15	
(F3)-F(R)G-10-99-12/13	133206
(F3)-FG-10-99-15	

F3 equivalent Seal Kit 919898

▲Included in 919450 Seal Kit

***Note**
 For -12 & -13 designs, assemble sleeve and valve as shown on front page with hole 30° from horizontal center line.

CAUTION
 Add lead chamfer to cross pin hole in hydrostat sleeve bore to prevent cutting "O" ring at assembly.