



## LV2P Series Filters

Flows to 110 L/min  
(29 USgpm)

Pressures to 100 bar  
(1500 PSI)



### Features and Benefits

- Designed to comply with ANSI specifications and ISO cleanliness standards.
- Visual, electrical, and electrical indicators with lamp options for system design flexibility.
- Zero leak by-pass valve construction.
- Wide range of element lengths for maximum design flexibility.
- High efficiency replacement elements in standard configurations (C-Pak) to meet Target Cleanliness Levels.
- High collapse elements available for non-bypass applications.

### DESIGN SPECIFICATIONS

<b>Rated flow:</b>	Length 3	60 L/min (16 USgpm)
	Length 6	110 L/min (29 USgpm)
<b>Housing &amp; Element Compatibility:</b>	Compatible with most petroleum oil, oil-in-water and water-in-oil fluids. Optional seals available for phosphate esters.	
<b>Temp range:</b>	-26°C to +121°C (-15°F to +250°F)	
<b>Pressure rating:</b>	Operating	100 bar (1500 PSI)
	Proof	258 bar (3750 PSI)
	Burst	420 bar (6090 PSI)
	Fatigue	100 bar (1500 PSI)
<b>Material:</b>	Head	Aluminum
	Bowl	Aluminum
<b>Dry weight:</b>	Length 3	4.1 kg (9 lbs)
(Approximate with element)	Length 6	6 kg (13.7 lbs)



# Dimensions

## LV2P Housing

mm (inch)

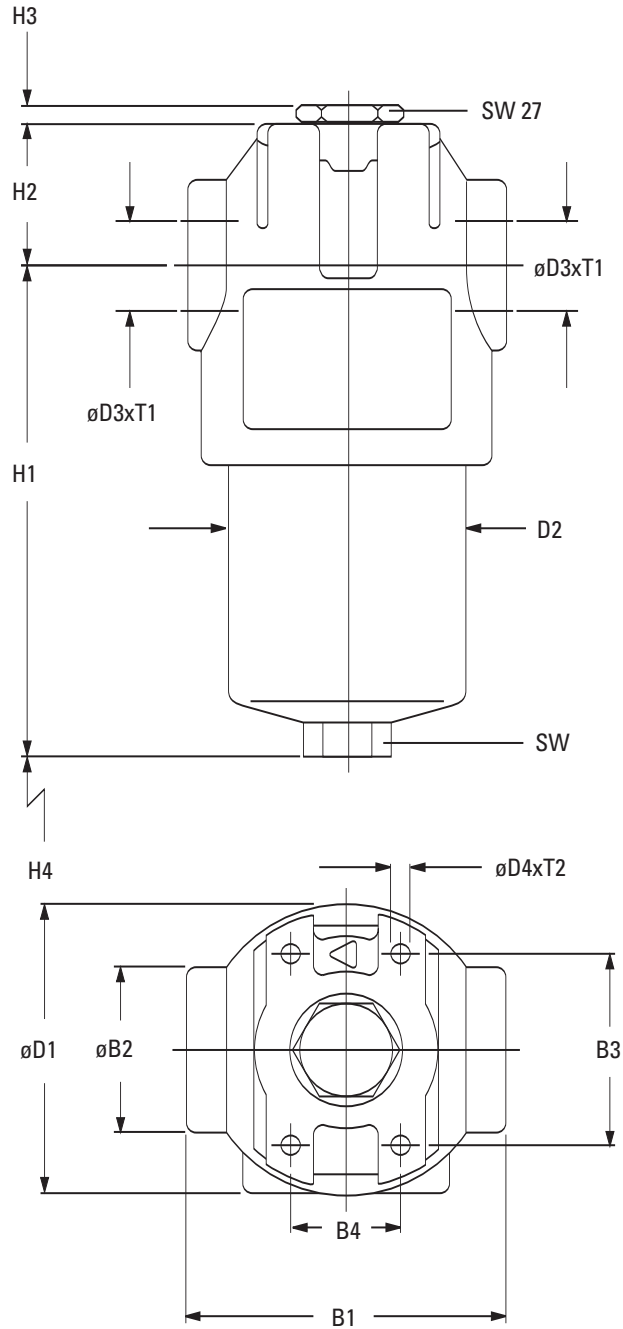

	Size B1	B2	B3	B4	D1	D2	D3	D4	H1	H2	H3	H4	SW	T1	T2
<b>Length 3</b>	91	50	56	32	83	68	SAE 12	1/4-28	140	40	7	75	24	17	9
<b>Length 6</b>	91	50	56	32	83	68	SAE 12	1/4-28	207	40	7	75	27	17	9

measurements are in millimeters

# Model Codes

## LV2P Series Filter Assembly Model Code

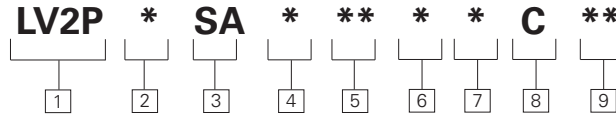

Sample model code:  
LV2P-1-SA-4-LN-B-3-C-05

**1 Filter Series**  
LV2P - Series

**2 Element Collapse Rating**  
1 - 250 PSI Low Collapse  
4 - 3000 PSI High Collapse

**3 Port options**  
SA - 1.062 - 12UN SAE-12  
(3/4" tube)

**4 Valve options**  
1 - Non-Bypass  
4 - Bypass set at 43 PSI  
cracking pressure  
6 - Bypass set at 90 PSI  
cracking pressure

**5 Indicator options**

**First Designator - Indicator Type**

A - Visual 70 PSI  
J - No Indicator (plug)  
L - Visual 30 PSI  
R - Electrical 30 PSI  
U - Electrical 70 PSI

**Second Designator - Electrical Receptical**

B - Brad Harrison  
H - Hirshman  
J - Hirshman with 24 volt light  
K - Hirshman with 115 volt light  
L - Hirshman with 230 volt light  
N - No Connector - use with  
visual indicators and "J"

**6 Seal material**

B - Buna-N  
V - Viton-A

Viton is a registered trademark of E.I. DuPont

7 Element length	Assembly length
3 - 84mm (3")	187mm (7.36")
6 - 152mm (6.0")	254mm (10.0")

**8 Element construction**  
C - Standard Construction

**9 Fluid cleanliness rating**

Code	Target fluid cleanliness level
03	16/14/12 or better
05	18/16/14 or better
10	20/18/15 or better
20	22/19/16 or better

The table assumes limited ingress/single pass of pump flow through element. For detailed assistance, see "The Systemic Approach to Contamination Control" or contact your local Eaton representative.

## V0513 Series Replacement Filter Element Model Codes

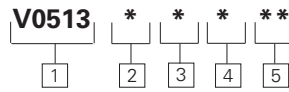

Sample model code:  
V0513-B-6-C-0505

**1 Filter element**  
V0513 - For use with LV2P series housings

**2 Seal material**

B - Buna-N  
V - Viton-A

Viton is a registered trademark of E.I. DuPont

**3 Element length**

mm (inch)  
3 - 84 (3)  
6 - 152 (6)

**4 Element construction**  
C - C-Pak (grade 3, 5, 10, 20)  
H - H-Pak (grade 3, 5, 10)

**5 Fluid cleanliness ratings**

Code	Target fluid cleanliness level
03	16/14/12 or better
05	18/16/14 or better
10	20/18/15 or better
20	22/19/16 or better

The table assumes limited ingress/single pass of pump flow through element. For detailed assistance, see "The Systemic Approach to Contamination Control" or contact your local Eaton representative.

### DESIGN SPECIFICATIONS

<b>Rated flow:</b>	Length 3 Length 6	60 L/min (16 USgpm) 110 L/min (29 USgpm)
<b>Housing &amp; Element Compatibility:</b>	Compatible with most petroleum oil, oil-in-water and water-in-oil fluids. Optional seals available for phosphate esters.	
<b>Temp range:</b>	-40°C to +121°C (-40°F to +250°F)	
<b>Construction:</b>	C-Pak or H Pak	

# LV2P Series Flow Data

Flow versus pressure drop:  
150 SUS (32 cSt) oil with  
specific gravity of <0.9

mm (inch)

## Housing Curves

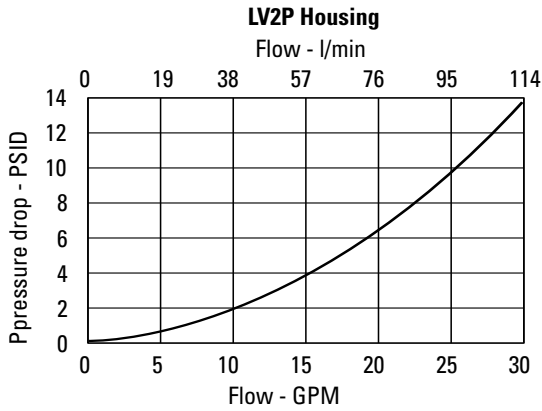

## Element Flow Curves

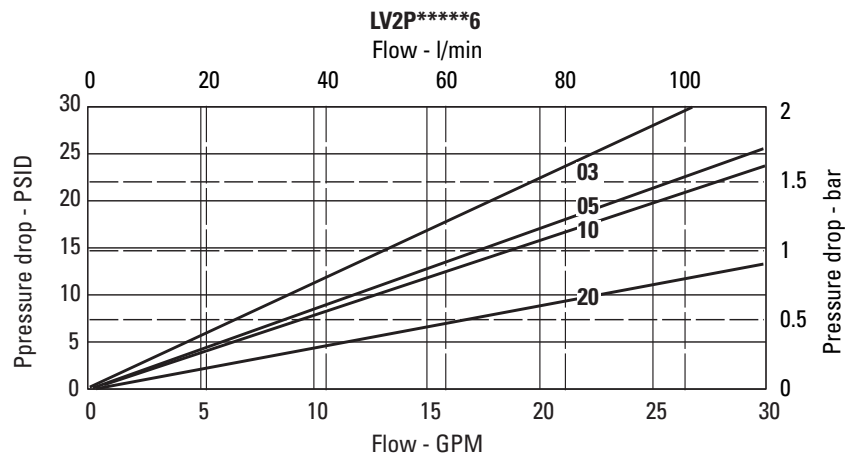
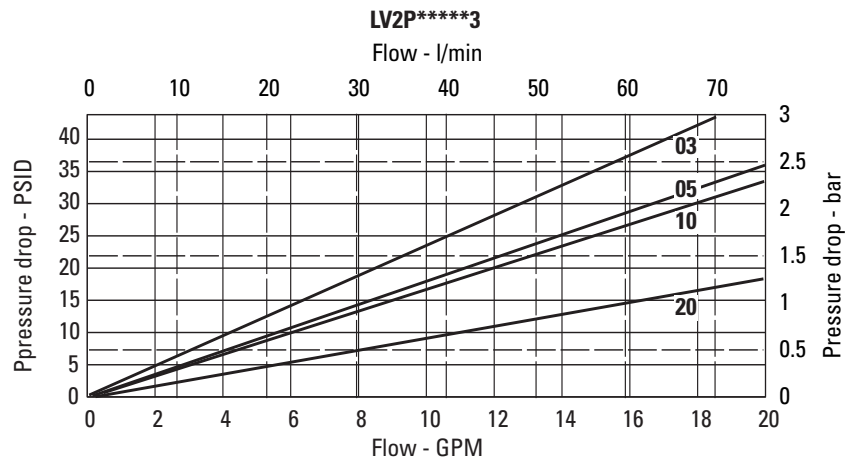

Eaton  
14615 Lone Oak Road  
Eden Prairie, MN 55344  
USA  
Tel: 952 937-9800  
Fax: 952 974-7722  
www.hydraulics.eaton.com

Eaton  
20 Rosamond Road  
Footscray  
Victoria 3011  
Australia  
Tel: (61) 3 9319 8222  
Fax: (61) 3 9318 5714

Eaton  
Eaton Fluid Power GmbH  
Dr.-Reckeweg-Str. 1  
D-76532 Baden-Baden, Germany  
Tel: +49 (0) 7221 682-0  
Fax: +49 (0) 7221 682-788



© 2004 Eaton Corporation  
All Rights Reserved  
Printed in USA  
Document No. V-FIFI-TB007-E  
September 2004